

BeadBuster

TM

XB-650i INDUSTRIAL

OWNERS MANUAL v1.1

**ONLINE
INSTRUCTIONS**

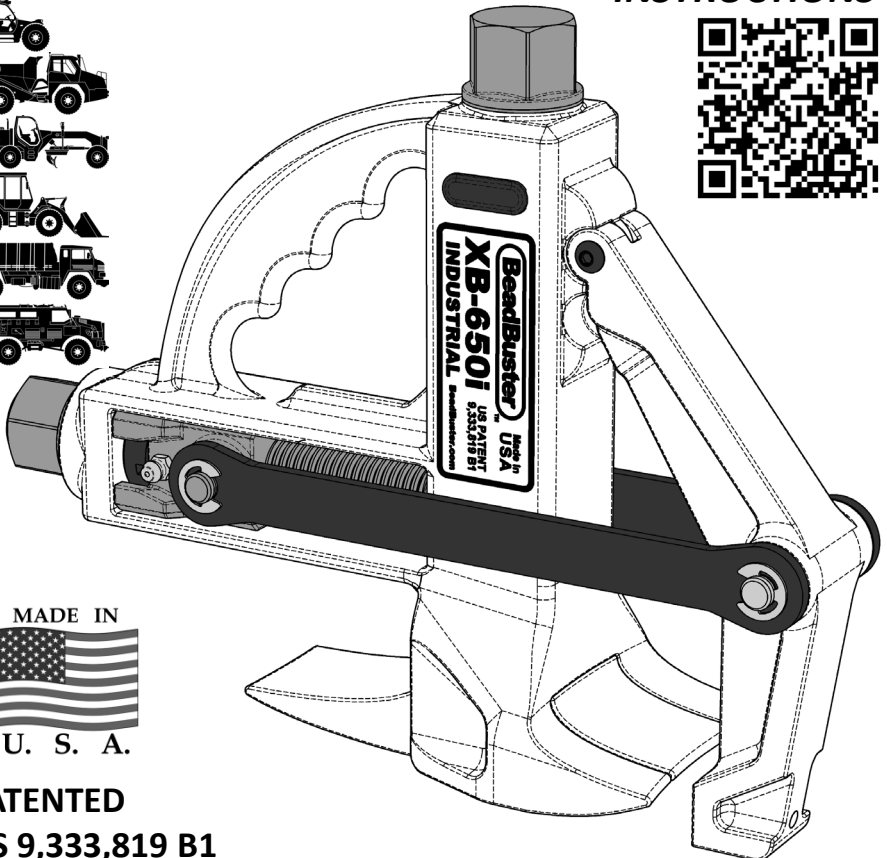

MADE IN



U. S. A.

PATENTED

US 9,333,819 B1

BEADBUSTER XB-650i PARTS

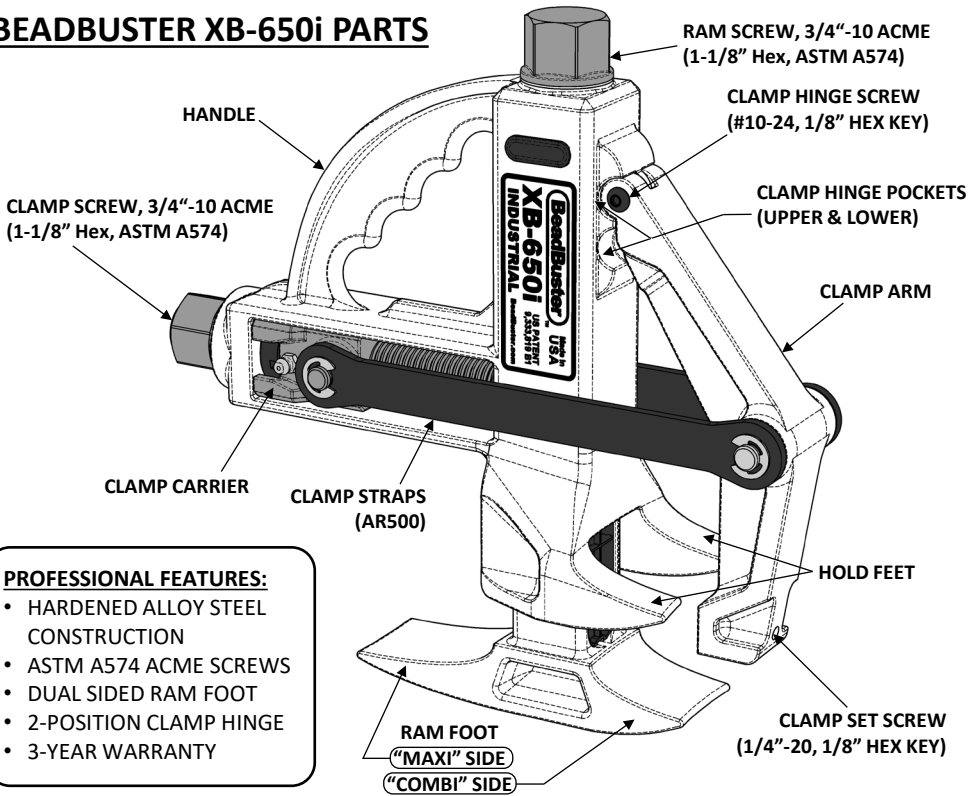

PROFESSIONAL FEATURES:

- HARDENED ALLOY STEEL CONSTRUCTION
- ASTM A574 ACME SCREWS
- DUAL SIDED RAM FOOT
- 2-POSITION CLAMP HINGE
- 3-YEAR WARRANTY

⚠ WARNING ⚠

To avoid serious personal injury, always wear proper protective gear, such as hard hats, safety glasses, gloves, and steel toe shoes when using industrial equipment. Failure to chock the wheels and crib the vehicle can result in serious injury or death. Always deflate tires before removing a wheel, a rim, or part of a rim clamp or nut. If you do not deflate the tire, the tire could explode, causing serious injury or death. Always stand to one side of the rim when using the Bead Breaker. Standing to one side of the bead breaker allows you to maintain control of the Bead Breaker. If it is not seated properly and flies off the rim, the bead breaker could cause serious injury or death.

SAFETY INFORMATION

To avoid personal injury or property damage while using this product, read and follow all **WARNINGS, CAUTIONS,** and **INSTRUCTIONS** that are attached to, or included with, this product.

1. Follow the instructions of the tire manufacturer and the vehicle manufacturer when deflating, demounting, mounting, and inflating tires.
2. These operating instructions do not apply to any specific rim. Therefore, contact the rim manufacturer for the correct procedure for your rim.
3. For the publication, "Multipiece Rim Matching Chart" contact the United States Department of Labor, Occupational Safety, and Health Administration (OSHA), Washington, DC, 20210, 202-219-6091, or contact BeadBuster LLC at 215-948-2302. If you are outside the U.S., contact your local government officials.
4. BeadBuster LLC cannot be held responsible for damage or injury resulting from unsafe use of this product; lack of maintenance; or incorrect product and system application.
5. Contact BeadBuster LLC when in doubt about safety precautions or applications.

⚠ CAUTION ⚠

The Bead Breaker, and all tire tools, should be used only by persons properly trained according to OSHA Regulation #29CFR1910.177, "Servicing Single-Piece & Multi-Piece Wheels."

Free copies of this regulation are available upon request from BeadBuster LLC.

⚠ WARNING ⚠

To avoid serious personal injury, always wear proper protective gear, such as hard hats, safety glasses, gloves, and steel toe shoes when using industrial equipment.

APPLICATIONS

The BeadBuster XB-650i will work on **1, 2 & 3-PC Wheels**. (Not compatible with 5-PC wheels)

1-PC: Larger wheels such as Tractors, Wheel Loaders, Skid Steers, OTR Construction Vehicles, etc.

2-PC: A less common style, but works on Fork Lifts, Heavy Trucks, Military Vehicles, etc.

3-PC: Telehandlers, Wheel Loaders, Graders, Haulers, Military Trucks, Mining Equipment, etc.

1-PC WHEEL

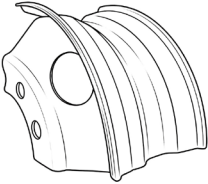

2-PC WHEEL

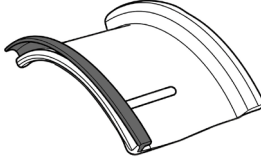

3-PC WHEEL

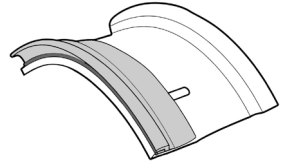

The XB-650i was designed to replace the function and application of the common styles of Hydraulic Bead Breakers from all manufacturers. The convertible features make it a direct replacement for the **COMBI, MAXI, and EURO STYLE** Hydraulic Bead Breakers giving it a 3-in-1 functionality, while being half the weight, more powerful, and free of hydraulic hoses.

"COMBI" STYLE

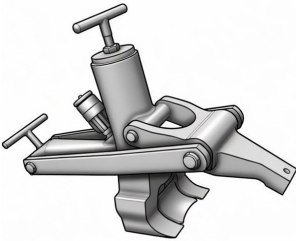

"MAXI" STYLE

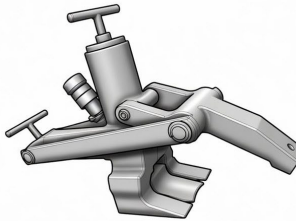

"EURO" STYLE

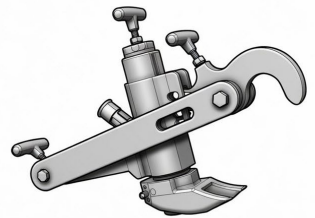

The XB-650i is equipped with a 2-Sided Ram Foot, which emulates the geometry of both the COMBI & MAXI style Hydraulic Bead Breakers. Simply run down the Ram Foot until it reaches the end of its threads, and the Foot can be removed and flipped around. Use care to avoid cross threading while re-installing the Ram Foot.

The **SHORT SIDE RAM FOOT ("COMBI" MODE)** will work for the majority of 1, 2 & 3-PC wheel applications.

The **LONG SIDE RAM FOOT ("MAXI" MODE)** will work on 3-PC wheels with extended flanges that have replaced older 5-PC wheels.

The XB-650i Ram Foot is capable of a Max pushing force of **28.7 Tons**, and 4 in of stroke.

**SHORT RAM FOOT
"COMBI"**

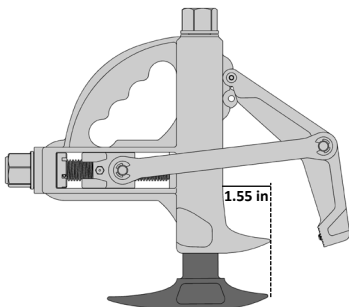

**LONG RAM FOOT
"MAXI"**

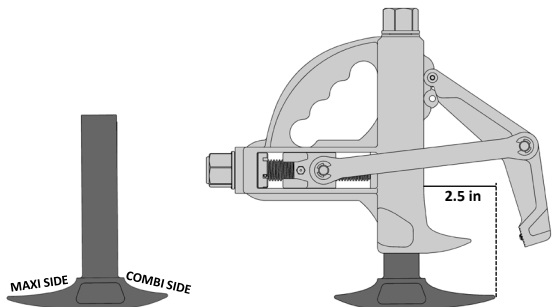

INSTRUCTIONS

REMOVE THE WHEEL

1. Chock the wheels opposite the jack.
2. Jack up the vehicle.
3. Crib the vehicle with safety stands or blocking devices after jacking it up. Do not work under an unblocked load.
4. Remove the valve core; deflate tires completely.

MOUNT THE BEAD BREAKER

1. Apply tire lubricant to the rim flange and tire bead.
2. Insert the tip of the ram feet in between the rim and tire bead. Using a hammer to urge the feet in place is discouraged, but if necessary, strike the back of the clamp screw.

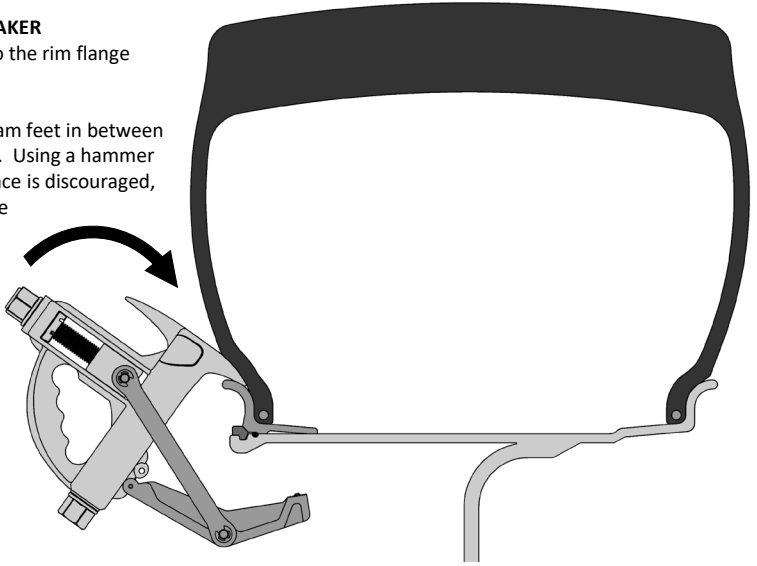

DUAL CLAMP ARM POSITION FOR DIFFERENT FLANGE WIDTHS

The XB-650i has (2) different Clamp Arm Hinge positions, an UPPER and LOWER position.

The UPPER position will be most commonly used with typical flange widths on 3-PC wheels.

The LOWER position can be used with wider flanges, allowing the Clamp Arm to reach further and around a wider rim flange.

The Clamp Arm can be removed by taking out the Clamp Hinge Screw with a 1/8" Hex Key.

The end of the Clamp Arm has a Set Screw that can be pushed out to get a better grip on hard-to-clamp wheels. Use a 1/8" Hex Key to adjust this Set Screw as well.

UPPER HINGE POSITION

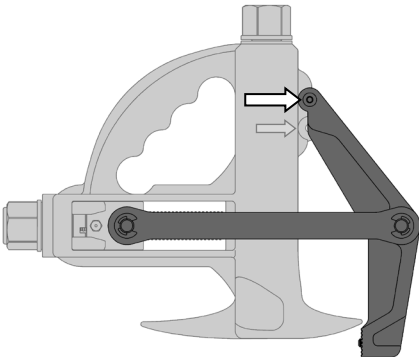

LOWER HINGE POSITION

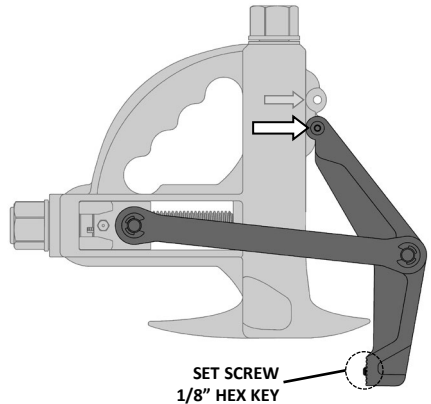

INSTRUCTIONS cont'd

CLAMP TO RIM

1. Once the feet are well seated under the lip of the rim, run down the Clamp Screw with an Impact Wrench and a 1-1/8" socket. Running the Clamp Screw **CLOCKWISE** will pull in the Clamp Arm, and **COUNTER-CLOCKWISE** will extend the Clamp Arm.
2. Apply more tire lubricant as needed, and run the clamp until the tool body is roughly perpendicular to the face of the rim. The tool can be tipped in toward the rim by a maximum of 5° past perpendicular.

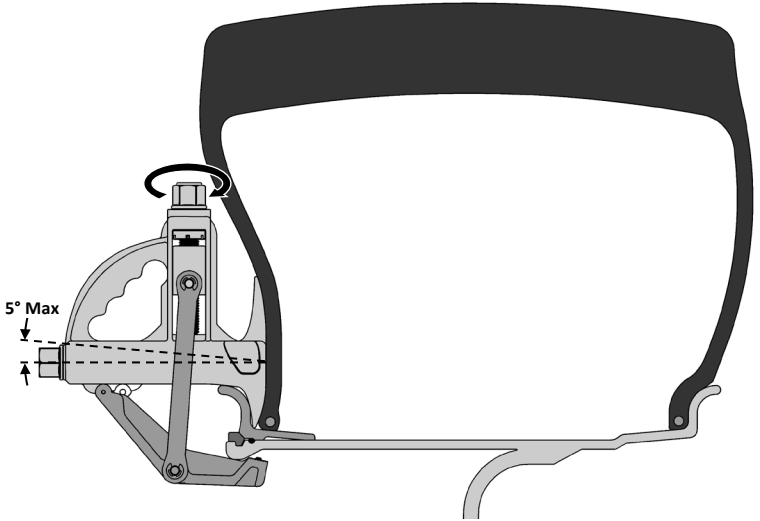

BREAK THE BEAD

1. Once the tool is in a mounted position, run down the Ram Screw with an Impact Wrench and a 1-1/8" socket. Running the Ram Screw **CLOCKWISE** will extend the Ram Foot, and **COUNTER-CLOCKWISE** will retract the Ram Foot.
2. The Max useful travel of the Ram Foot is 4 in., and the operator must be mindful to not extend the foot past that limit. *(more info on the next page)*

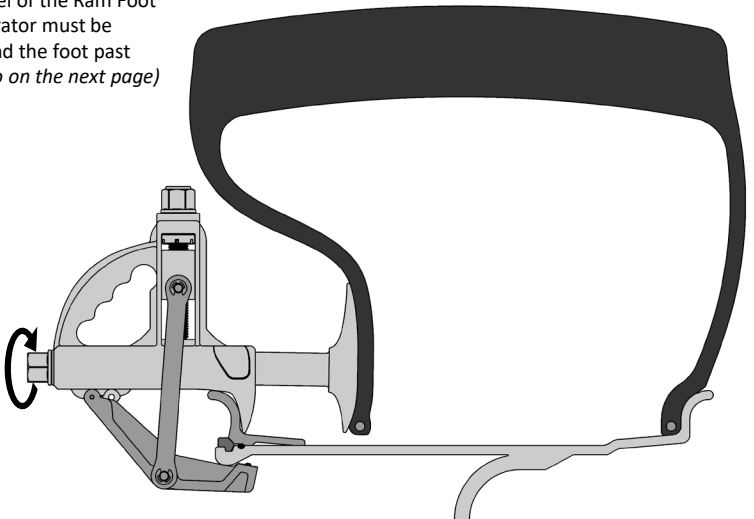

⚠ CAUTION – RAM FOOT TRAVEL LIMIT ⚠

The XB-650i Ram Foot is designed to have a MAX travel of 4 in. It is not necessary to push the sidewall more than this to break the bead.

At MAX travel, the Ram threads have roughly 33% of normal thread engagement. If the Ram Screw is run down until the Foot stops advancing, the threads will be disengaged and only the back pressure of the tire will keep the Foot in place. There are features in the Ram Screw to help the threads re-engage, but care must be used when returning the Ram Foot to not get cross-threaded.

To return the Ram Foot after it has stopped advancing, go slow and stop if the threads seem to have unusual resistance.

There are visual markers on both sides of the Ram Foot to act as a visual indicator when you are nearing the end of the 4" Travel Limit. The operator should make a practice of looking for these indicators when using the tool to prevent over-extension of the Ram Foot.

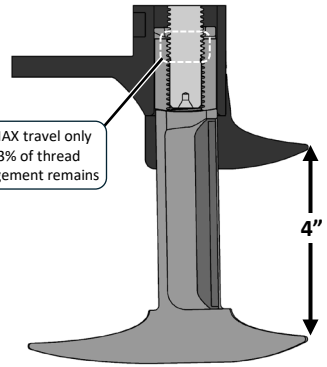

"COMBI" MODE

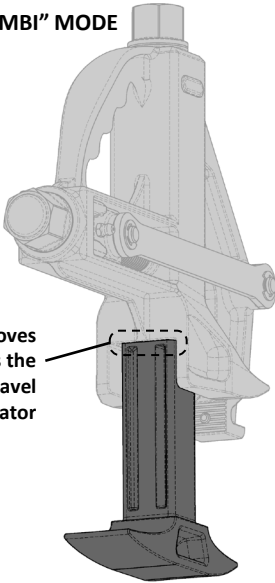

Top of the grooves being visible is the End-of-Travel indicator

"MAXI" MODE

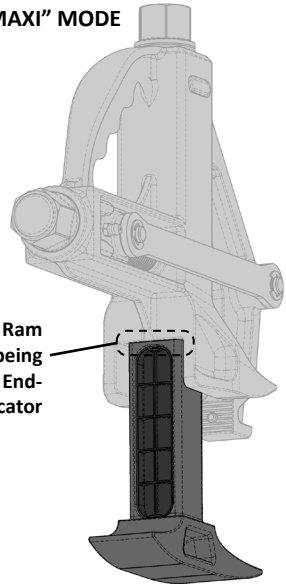

Top of the Ram Foot Cover being visible is the End-of-Travel indicator

MOVE AROUND THE RIM AND REPEAT

1. After breaking the Tire Bead in one spot, return the Ram Foot and open up the Clamp, and move the tool to another location 8-10 in along the circumference of the wheel, and repeat the bead breaking procedure.
2. Repeat this process 3 or 4 times around the Wheel Flange as necessary to completely break the Tire Bead.

BeadBuster XB-650i SPECS:

WEIGHT: 13.3 lbs

SIZE: 11" x 9" x 3"

MAX CLAMP FORCE: 15.7 Tons

MAX RAM FORCE: 28.7 Tons

RAM EXTENSION: 4.0 in

MAX FLANGE WIDTH: 4.75"



MAINTENANCE

GREASE THE CLAMP CARRIER

Apply fresh grease to the clamp carrier using the grease fitting after every 50-100 uses, or at least once per season. The XB-650i is greased at the factory with White Lithium grease with PTFE additive. This is preferred, but any general purpose grease will work.

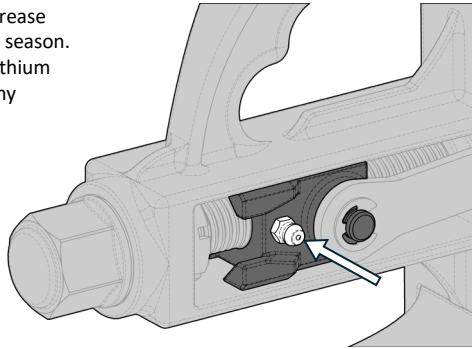

GREASE THE RAM THREADS

Remove the Ram Foot Cover with pliers and/or a small flat head screw driver, clean out the old dirty grease and pack with fresh grease. You must leave enough room in the Ram Foot Cavity for the Ram Screw and the Ram Foot Cover.

No more than 0.60 oz (17.6 ml, 3.5 tsp) of grease should be used to refill the Cavity. This will correspond to roughly 24% of the cavity volume being filled with grease. If too much grease is used, excess will squeeze out with the next use, and potentially impair tool function.

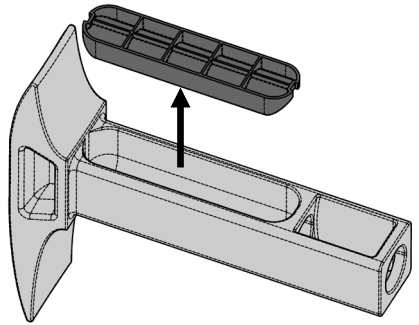

Re-grease after every 50-100 uses, or at least once per season. After re-greasing, replace the Ram Foot Cover and set it in place with a mallet.

REBUILD KIT SUB-ASSEMBLIES *(available on BeadBuster.com)*

CLAMP ARM (CA)

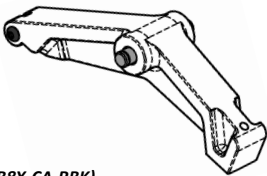

(BB8X-CA-RBK)

CLAMP SCREW (CSW)

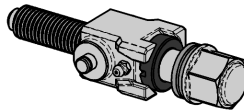

(BB8X-CSW-RBK)

RAM SCREW (RS)

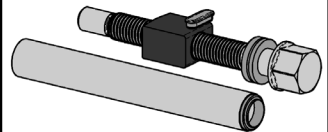

(BB8X-RS-RBK)

CLAMP STRAP (CSP)

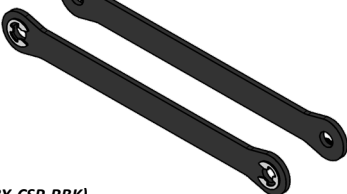

(BB8X-CSP-RBK)

RAM FOOT (RF)

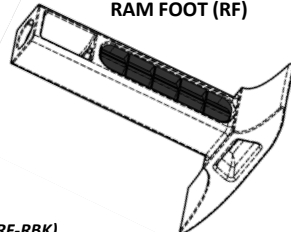

(BB8X-RF-RBK)

PARTS LIST

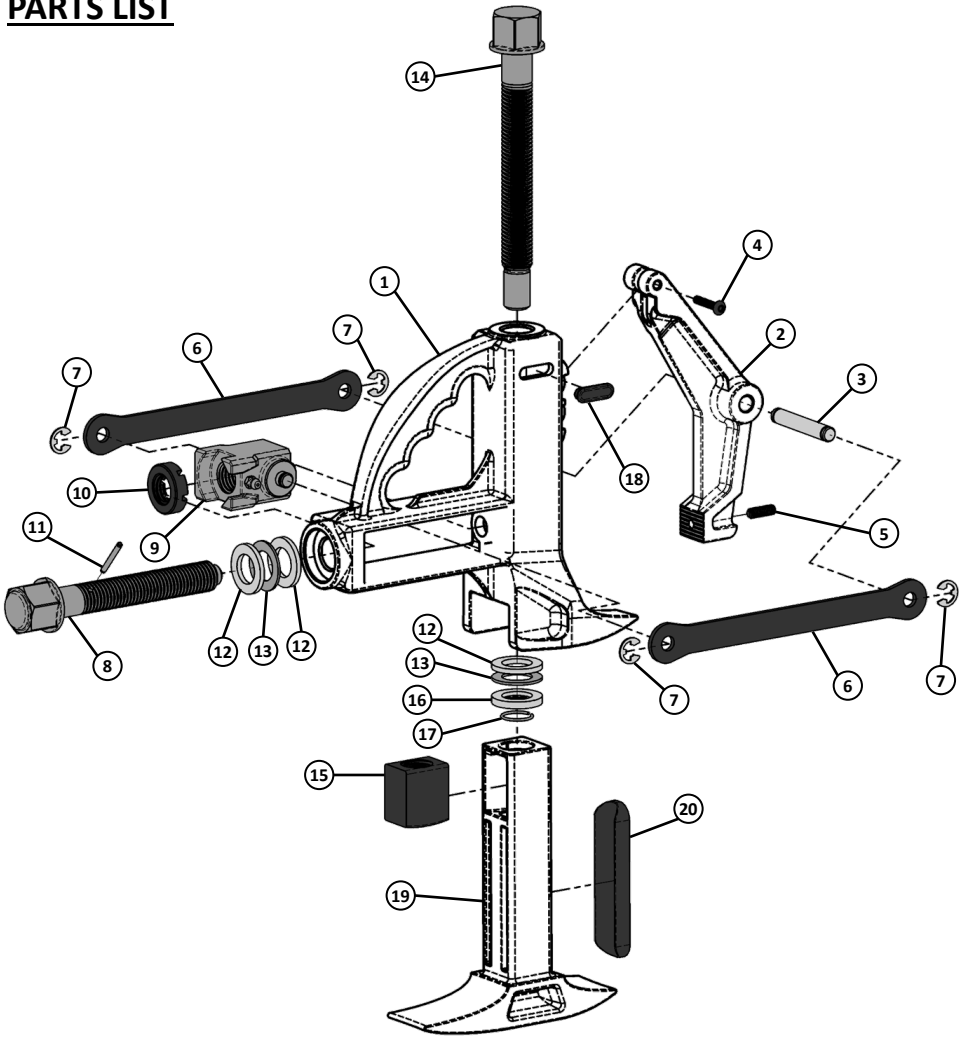

ITEM NO.	SUB ASSY	PART NO.	QTY	DESCRIPTION	ITEM NO.	SUB ASSY	PART NO.	QTY	DESCRIPTION
1	-	BB8X-0614	1	Body Frame	11	CSW	BB8X-H16	1	Roll Pin, 1/8" x 1-1/8"
2	CA	BB8X-0601	1	Clamp Arm	12	CSW/RS	BB8X-0510	3	Thrust Washer
3	CA	BB8X-H18	1	Clevis Pin	13	CSW/RS	BB8X-H29	2	Oilite Thrust Bearing
4	CA	BB8X-H30	1	BHCS, #10-24 x 1"	14	RS	BB8X-H22	1	Ram Screw
5	CA	BB8X-H05	1	Set Screw, 1/4"-20 x 3/4"	15	RS	BB8X-0609	1	Ram Nut
6	CSP	BB8X-0615	2	Clamp Strap	16	RS	BB8X-0511	1	Thrust Washer Ring Retainer
7	CSP	BB8X-H25	4	External Retaining Clip	17	RS	BB8X-H26	1	Hog Ring
8	CSW	BB8X-H23	1	Clamp Screw	18	RS	BB8X-0618	1	Body Window Plug
9	CSW	BB8X-0616	1	Clamp Carrier	19	RF	BB8X-0605	1	Ram Foot
10	CSW	BB8X-H28	1	Castle Nut	20	RF	BB8X-0617	1	Ram Foot Cover

BeadBuster

711 Vallamont Dr.
Williamsport, PA 17701

©2026 BeadBuster. All rights reserved.

www.BeadBuster.com

info@beadbuster.com

p. 215-948-2302



6 72975 26941 8